

Licensing Sub-Committee Report

Item No:	
Date:	6 th April 2017
Licensing Ref No:	17/01088/LIPN - New Premises Licence
Title of Report:	Leon Astoria House 62 Shaftesbury Avenue London
Report of:	Director of Public Protection and Licensing
Wards involved:	St James's
Policy context:	City of Westminster Statement of Licensing Policy
Financial summary:	None
Report Author:	Miss Yolanda Wade Senior Licensing Officer
Contact details	Telephone: 020 7641 1872 Email: ywade@westminster.gov.uk

1. Application

1-A Applicant and premises			
Application Type:	New Premises Licence, Licensing Act 2003		
Application received date:	1 February 2017		
Applicant:	Leon Restaurants Limited		
Premises:	Leon		
Premises address:	Astoria House 62 Shaftesbury Avenue London W1D 6LT	Ward:	St James's
		Cumulative Impact Area:	West End
Premises description:	<p>According to the application, the premises will operate predominantly as a restaurant, serving food, soft drinks and alcohol for consumption on the premises. The premises may also sell products for consumption off the premises as part of a takeaway meal.</p> <p>However as drafted, the application will allow the premises to be used exclusively or primarily for alcohol on consumption on premises which is contrary to policy.</p>		
Premises licence history:	This premises has not previously benefitted from a licence under the Licensing Act 2003.		
Applicant submissions:	None submitted		

1-B Proposed licensable activities and hours							
Regulated Entertainment							
Live Music:				Indoors, outdoors or both			Indoors
Day:	Mon	Tues	Wed	Thur	Fri	Sat	Sun
Start:	09:00	09:00	09:00	09:00	09:00	09:00	09:00
End:	23:30	23:30	23:30	23:30	00:00	00:00	22:30
Seasonal variations/ Non-standard timings:			Sundays immediately prior to Bank Holidays - 09:00hrs to midnight				

Recorded Music:				Indoors, outdoors or both			Indoors
Day:	Mon	Tues	Wed	Thur	Fri	Sat	Sun
Start:	09:00	09:00	09:00	09:00	09:00	09:00	09:00
End:	23:30	23:30	23:30	23:30	00:00	00:00	22:30
Seasonal variations/ Non-standard timings:			Sundays immediately prior to Bank Holidays - 09:00hrs to midnight				

Performance of Dance				Indoors, outdoors or both			Indoors
Day:	Mon	Tues	Wed	Thur	Fri	Sat	Sun
Start:	09:00	09:00	09:00	09:00	09:00	09:00	09:00
End:	23:30	23:30	23:30	23:30	00:00	00:00	22:30
Seasonal variations/ Non-standard timings:			Sundays immediately prior to Bank Holidays - 09:00 to midnight				

Anything of a similar description				Indoors, outdoors or both			Indoors
Day:	Mon	Tues	Wed	Thur	Fri	Sat	Sun
Start:	09:00	09:00	09:00	09:00	09:00	09:00	09:00
End:	23:30	23:30	23:30	23:30	00:00	00:00	22:30
Seasonal variations/ Non-standard timings:			Sundays immediately prior to Bank Holidays - 09:00 to midnight				

Late Night Refreshment				Indoors, outdoors or both			Both
Day:	Mon	Tues	Wed	Thur	Fri	Sat	Sun
Start:	23:00	23:00	23:00	23:00	23:00	23:00	23:00
End:	00:00	00:00	00:00	00:00	00:00	00:00	00:00
Seasonal variations/ Non-standard timings:			None				

Sale by retail of alcohol				On or off sales or both:			Both
Day:	Mon	Tues	Wed	Thur	Fri	Sat	Sun
Start:	10:00	10:00	10:00	10:00	10:00	10:00	12:00
End:	23:30	23:30	23:30	23:30	00:00	00:00	22:30
Seasonal variations/ Non-standard timings:			Sundays immediately prior to a Bank holiday - midday to midnight				

Hours premises are open to the public							
Day:	Mon	Tues	Wed	Thur	Fri	Sat	Sun
Start:	07:00	07:00	07:00	07:00	07:00	07:00	07:00
End:	00:00	00:00	00:00	00:00	00:00	00:00	00:00
Seasonal variations/ Non-standard timings:			None				
Adult Entertainment:			Not applicable				

2. Representations

2-A Responsible Authorities	
Responsible Authority:	Metropolitan Police Service
Representative:	PC Michael Day
Received:	9 th February 2017
<p>With reference to the above application, I am writing to inform you that the Metropolitan Police, as a responsible authority, are making a representation. It is our belief that if granted the application would undermine the Licensing Objectives.</p> <p>The venue is situated inside the West End Cumulative Impact Area, a locality where this is traditionally high crime and disorder but I believe this application may cause further policing problems in the area which I will be looking into further.</p>	
Responsible Authority:	Environmental Health Consultation Team
Representative:	Mr Dave Nevitt
Received:	9 th February 2017
<p>I wish to make Representations on the following grounds:</p> <p>Representation is made in relation to the application, as the proposals are likely to increase Public Nuisance and may impact upon Public Safety.</p> <p>The premises is located in the West End Cumulative Impact Area.</p>	
Responsible Authority:	The Licensing Authority
Representative:	Mr Steve Rowe
Received:	1 st March 2017
<p>As a responsible authority under section 13 (4) of the Licensing Act 2003 as amended under the Police and Social Responsibility Act 2011 the Licensing Authority have considered your application in full. The Licensing Authority has concerns in relation to this application and how the premises would promote the Licensing Objectives:</p> <ul style="list-style-type: none"> • Public Nuisance • Prevention of Crime & Disorder • Public Safety • Protection of Children from Harm <p>As it stands the application contravenes Westminster's Statement of Licensing Policies CIP1,</p>	

HRS1, RNT2 and MD2. The premises is located inside the Cumulative Impact Area.

The applicant has applied to:

- To permit the Performance of Live Music ‘indoors’, Recorded Music ‘indoors’, the Performance of Dance ‘indoors’ and anything similar of a similar description to Live Music, Recorded Music or Performance of Dance on Sunday from 09:00 to 23:30 Monday to Thursday, from 09:00 to midnight Friday to Saturday and from 09:00 to 22:30 on Sundays except Sundays preceding a bank holiday until midnight.
- To add the provision of Late Night Refreshment ‘indoors’ and outdoors’ from 23:00 to 00:00 Monday to Sunday.
- To permit the Supply of Alcohol both ‘on’ and ‘off’ the premises from 10:00 to 23:30 Monday to Thursday, from 10:00 to midnight Friday to Saturday and from 12:00 to 22:30 on Sundays except Sundays preceding a bank holiday until midnight.

Policy HRS1 states at paragraph 2.3.2: “It is the intention to generally grant licences... where the hours when customers are permitted to be on the premises are within the ‘core hours’ as set out in Policy HRS1. This is not a policy to refuse applications for longer hours than the core hours and consideration will in all cases be given to the individual merits of an application. Where a proposal is made to operate outside these core hours each application will be considered on its merits against the criteria as set out in paragraph (ii) (of Policy HRS1)”.

Policy CIP1 states (i) It is the Licensing Authority’s policy to refuse applications in the Cumulative Impact Areas for: pubs and bars, fast food premises, and premises offering facilities for music and dancing; other than applications to vary hours within the Core Hours under Policy HRS1. However part (ii) states: Applications for other licensable activities in the Cumulative Impact Areas will be subject to other policies, and must demonstrate that they will not add to cumulative impact in the Cumulative Impact Areas.

Policy RNT2 which relates to restaurants within the CIA states ‘Applications will be granted subject to other policies in this Statement and subject to the relevant criteria in Policies CD1, PS1, PN1 and CH1, provided it can be demonstrated that they will not add to cumulative impact in the Cumulative Impact Areas.

Policy MD2 which relates to music and dance premises and similar entertainment states ‘It is the Licensing Authority’s policy to refuse applications in the CIA other than applications to vary the hours within the core hours under policy HRS1’.

3. Policy & Guidance

The following policies within the City Of Westminster Statement of Licensing Policy apply:

Policy CIA1 applies:

(i) It is the Licensing Authority’s policy to refuse applications in the Cumulative Impact Areas for: pubs and bars, fast food premises, and premises offering facilities for music and dancing; other than applications to vary hours within the Core Hours under Policy HRS1.

Policy HRS1 applies:	<p>(ii) Applications for other licensable activities in the Cumulative Impact Areas will be subject to other policies, and must demonstrate that they will not add to cumulative impact in the Cumulative Impact Areas.</p> <p>(i) Applications for hours within the core hours set out below in this policy will generally be granted, subject to not being contrary to other policies in the Statement of Licensing Policy.</p> <p>(ii) Applications for hours outside the core hours set out below in this policy will be considered on their merits, subject to other relevant policies.</p>
Policy PB2 applies:	<p>It is the Licensing Authority's policy to refuse applications in the Cumulative Impact Areas other than applications to vary hours within the Core Hours under Policy HRS1.</p>

4. Appendices

Appendix 1	Premises plans
Appendix 2	Applicant supporting documents
Appendix 3	Premises history
Appendix 4	Proposed conditions
Appendix 5	Residential map and list of premises in the vicinity

Report author:	Miss Yolanda Wade Senior Licensing Officer
Contact:	Telephone: 020 7641 1872 Email: ywade@westminster.gov.uk

If you have any queries about this report or wish to inspect one of the background papers please contact the report author.

Background Documents – Local Government (Access to Information) Act 1972

1	Licensing Act 2003	N/A
2	City of Westminster Statement of Licensing Policy	7 th January 2016
3	Amended Guidance issued under section 182 of the Licensing Act 2003	March 2015
4	Application Form	1 st February 2017

5	Representation from the Metropolitan Police	9 th February 2017
6	Representation from the Environmental Health Service	9 th February 2017
7	Representation from the Licensing Service	1 st March 2017

Premises Plans

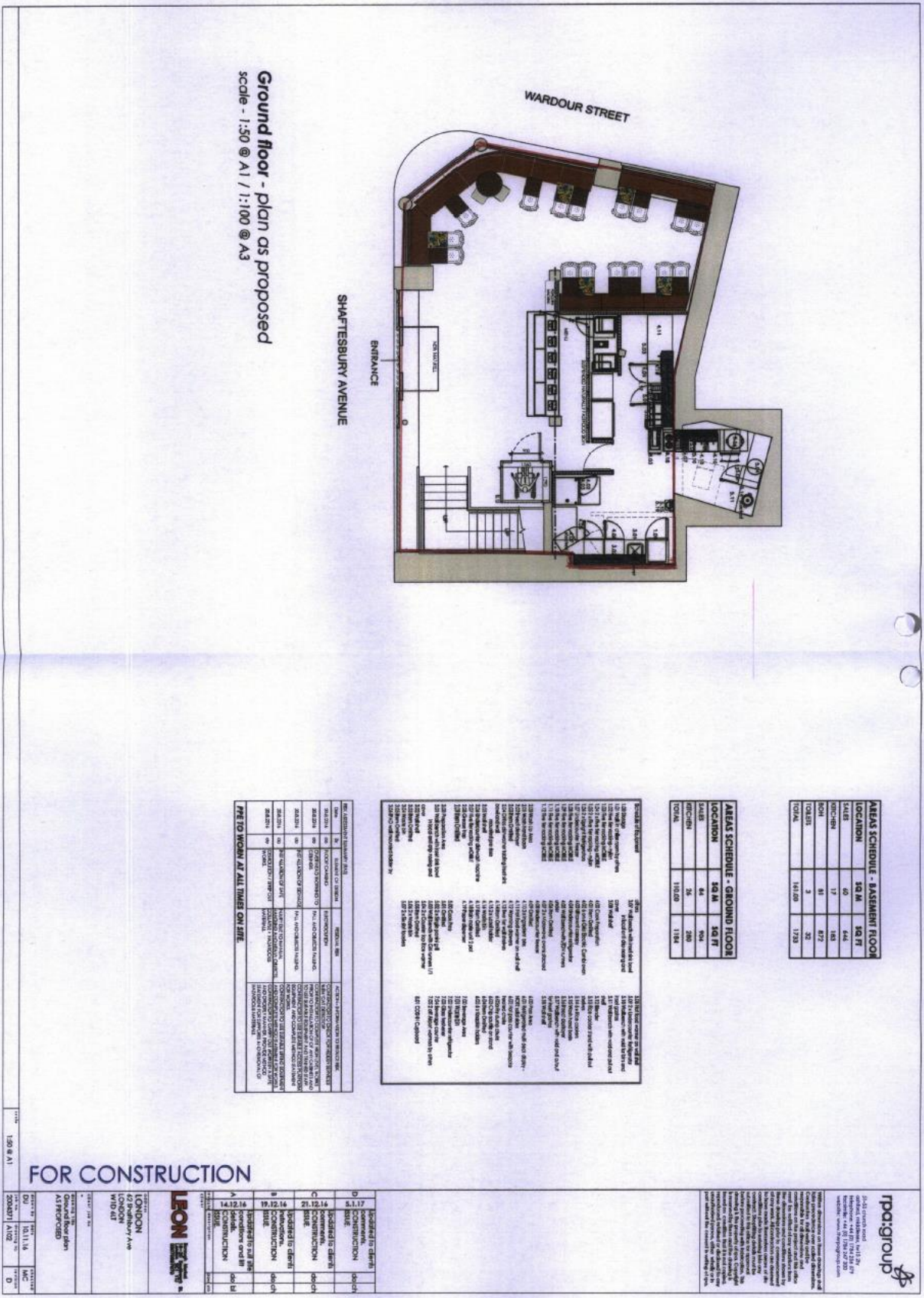

Ground floor - plan as proposed
scale - 1:50 @ A1 / 1:100 @ A3

AREAS SCHEDULE - BASEMENT FLOOR

LOCATION	IQ.M	SG.FT
STAIRS	45	444
RECEPTION	12	118
KITCHEN	81	873
TOILETS	3	28
OTHER	141.00	1733

AREAS SCHEDULE - GROUND FLOOR

LOCATION	IQ.M	SG.FT
STAIRS	44	404
RECEPTION	56	500
OTHER	115.00	1184

REVISIONS

NO.	DESCRIPTION	DATE
1	ISSUED FOR PERMIT	15/08/11
2	ISSUED FOR CONSTRUCTION	15/08/11

PER TO WORK AT ALL TIMES ON SITE

NO.	DESCRIPTION	DATE
1	ISSUED FOR PERMIT	15/08/11
2	ISSUED FOR CONSTRUCTION	15/08/11

FOR CONSTRUCTION

rpa:group

30-35 North Road
London EC1A 4DF
Tel: 020 7493 2200
www.rpagroup.com

LEON

LEON
LONDON
LONDON
W1D 6ET

15/08/11

Applicant Supporting Documents

None submitted

Premises History

There is no licence or appeal history for the premises.

CONDITIONS CONSISTENT WITH THE OPERATING SCHEDULE AND CONDITIONS PROPOSED BY A PARTY TO THE HEARING

When determining an application for a new premises licence under the provisions of the Licensing Act 2003, the licensing authority must, unless it decides to reject the application, grant the licence subject to the conditions which are indicated as mandatory in this schedule.

At a hearing the licensing authority may, in addition, and having regard to any representations received, grant the licence subject to such conditions which are consistent with the operating schedule submitted by the applicant as part of their application, or alter or omit these conditions, or add any new condition to such extent as the licensing authority considers necessary for the promotion of the licensing objectives.

This schedule lists those conditions which are consistent with the operating schedule, or proposed as necessary for the promotion of the licensing objectives by a responsible authority or an interested party as indicated. These conditions have not been submitted by the licensing service but reflect the positions of the applicant, responsible authority or interested party and have not necessarily been agreed

Mandatory Conditions

1. No supply of alcohol may be made at a time when there is no designated premises supervisor in respect of this licence.
2. No supply of alcohol may be made at a time when the designated premises supervisor does not hold a personal licence or the personal licence is suspended.
3. Every supply of alcohol under this licence must be made or authorised by a person who holds a personal licence.
4.
 - (1) The responsible person must ensure that staff on relevant premises do not carry out, arrange or participate in any irresponsible promotions in relation to the premises.
 - (2) In this paragraph, an irresponsible promotion means any one or more of the following activities, or substantially similar activities, carried on for the purpose of encouraging the sale or supply of alcohol for consumption on the premises—
 - (a) games or other activities which require or encourage, or are designed to require or encourage, individuals to;
 - (i) drink a quantity of alcohol within a time limit (other than to drink alcohol sold or supplied on the premises before the cessation of the period in which the responsible person is authorised to sell or supply alcohol), or
 - (ii) drink as much alcohol as possible (whether within a time limit or otherwise);
 - (b) provision of unlimited or unspecified quantities of alcohol free or for a fixed or discounted fee to the public or to a group defined by a particular characteristic in a manner which carries a significant risk of undermining a licensing objective;

- (c) provision of free or discounted alcohol or any other thing as a prize to encourage or reward the purchase and consumption of alcohol over a period of 24 hours or less in a manner which carries a significant risk of undermining a licensing objective;
 - (d) selling or supplying alcohol in association with promotional posters or flyers on, or in the vicinity of, the premises which can reasonably be considered to condone, encourage or glamorise anti-social behaviour or to refer to the effects of drunkenness in any favourable manner;
 - (e) dispensing alcohol directly by one person into the mouth of another (other than where that other person is unable to drink without assistance by reason of a disability).
5. The responsible person must ensure that free potable water is provided on request to customers where it is reasonably available.
6. (1) The premises licence holder or club premises certificate holder must ensure that an age verification policy is adopted in respect of the premises in relation to the sale or supply of alcohol.
- (2) The designated premises supervisor in relation to the premises licence must ensure that the supply of alcohol at the premises is carried on in accordance with the age verification policy.
- (3) The policy must require individuals who appear to the responsible person to be under 18 years of age (or such older age as may be specified in the policy) to produce on request, before being served alcohol, identification bearing their photograph, date of birth and either—
- (a) a holographic mark, or
 - (b) an ultraviolet feature.
7. The responsible person must ensure that—
- (a) where any of the following alcoholic drinks is sold or supplied for consumption on the premises (other than alcoholic drinks sold or supplied having been made up in advance ready for sale or supply in a securely closed container) it is available to customers in the following measures—
 - (i) beer or cider: ½ pint;
 - (ii) gin, rum, vodka or whisky: 25 ml or 35 ml; and
 - (iii) still wine in a glass: 125 ml;
 - (b) these measures are displayed in a menu, price list or other printed material which is available to customers on the premises; and
 - (c) where a customer does not in relation to a sale of alcohol specify the quantity of alcohol to be sold, the customer is made aware that these measures are available.

A responsible person in relation to a licensed premises means the holder of the premise licence in respect of the premises, the designated premises supervisor (if any) or any individual aged 18 or over who is authorised by either the licence holder or designated premises supervisor.

For premises with a club premises certificate, any member or officer of the club present on the premises in a capacity that which enables him to prevent the supply of alcohol.

8(i) A relevant person shall ensure that no alcohol is sold or supplied for consumption on or off the premises for a price which is less than the permitted price.

8(ii) For the purposes of the condition set out in paragraph 8(i) above -

(a) "duty" is to be construed in accordance with the Alcoholic Liquor Duties Act 1979;

(b) "permitted price" is the price found by applying the formula -

$$P = D + (D \times V)$$

Where -

(i) P is the permitted price,

(ii) D is the amount of duty chargeable in relation to the alcohol as if the duty were charged on the date of the sale or supply of the alcohol, and

(iii) V is the rate of value added tax chargeable in relation to the alcohol as if the value added tax were charged on the date of the sale or supply of the alcohol;

(c) "relevant person" means, in relation to premises in respect of which there is in force a premises licence -

(i) the holder of the premises licence,

(ii) the designated premises supervisor (if any) in respect of such a licence, or

(iii) the personal licence holder who makes or authorises a supply of alcohol under such a licence;

(d) "relevant person" means, in relation to premises in respect of which there is in force a club premises certificate, any member or officer of the club present on the premises in a capacity which enables the member or officer to prevent the supply in question; and

(e) "value added tax" means value added tax charged in accordance with the Value Added Tax Act 1994.

8(iii). Where the permitted price given by Paragraph 8(ii)(b) above would (apart from this paragraph) not be a whole number of pennies, the price given by that sub-paragraph shall be taken to be the price actually given by that sub-paragraph rounded up to the nearest penny.

8(iv). (1) Sub-paragraph 8(iv)(2) below applies where the permitted price given by Paragraph 8(ii)(b) above on a day ("the first day") would be different from the permitted price on the next day ("the second day") as a result of a change to the rate of duty or value added tax.

(2) The permitted price which would apply on the first day applies to sales or supplies of alcohol which take place before the expiry of the period of 14 days beginning on the second day.

Proposed Conditions by Applicant as part of Operating Schedule

9. All alcohol purchased for consumption off the premises will be in sealed containers and as part of a takeaway meal other than drinks purchased for consumption in any outside seating area.
10. The supply of alcohol for consumption on the premises shall be to customers who will be seated at tables.
11. The supply of alcohol shall be by counter staff, waiter/waitress.
12. Persons under the age of 18 are allowed on the premises and staff will be suitably trained to ensure that there is no provision of alcohol to persons under 18 years old.

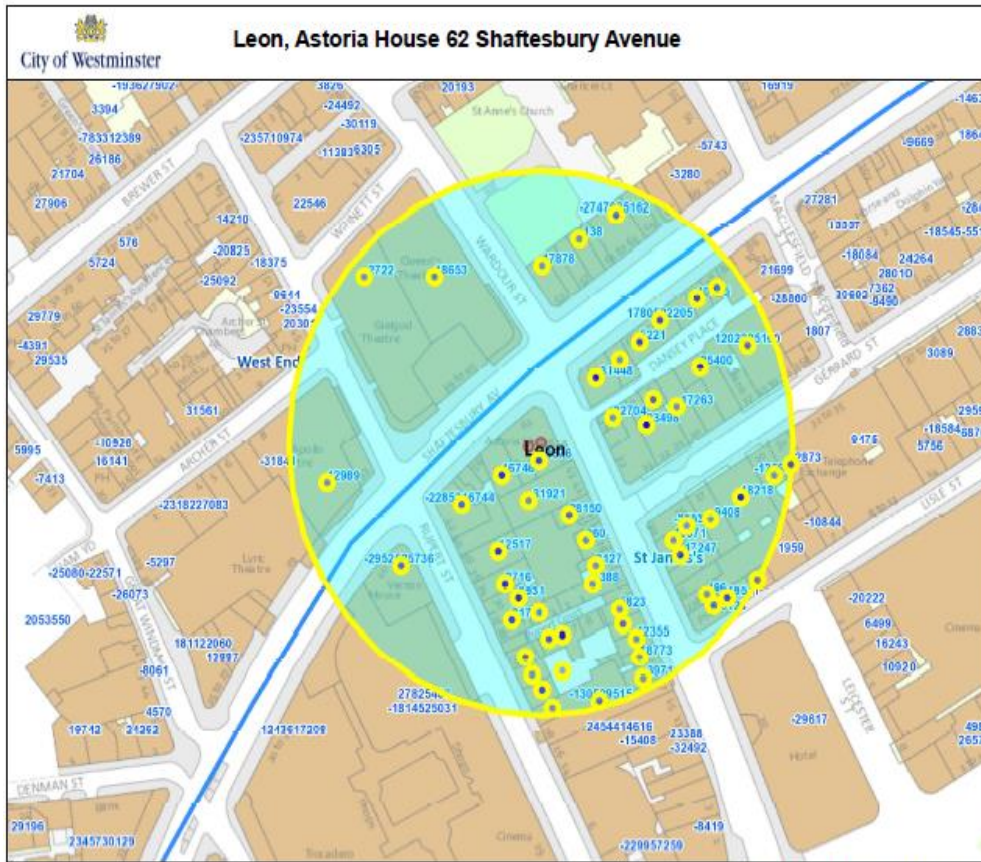

Residential / Proposed Residential	73
Under Construction	None
Other Uses	None
Proportion Residential of all Uses	None

10
 Meters

This product includes mapping data licensed from Ordnance Survey with the permission of the Controller of Her Majesty's Stationary Office. © Crown copyright and/or database right 2013. All rights reserved. Licence number LA 100019597

Data Source: Uniform Database
 Date: 21/03/2017

Premises within 75 metres of: Leon, Astoria House 62 Shaftesbury Avenue

p / n	Name of Premises	Premises Address	Licensed Hours
12517	Sports Bar And Grill	36 - 40 Rupert Street London W1D 6DN	Monday to Saturday 10:00 - 01:30 Sunday 12:00 - 01:00
12022	Dumplings' Legend	Basement To First Floor 15 - 16 Gerrard Street London W1D 6JB	Monday to Saturday 10:00 - 03:00 Sunday 12:00 - 00:00
8127	Sunrise Cafe And News	Ground Floor 31 Wardour Street London W1D 6PT	Monday to Saturday 08:00 - 05:00 Sunday 10:00 - 05:00
496	HK Diner	22A Wardour Street London W1D 6QH	Monday to Saturday 10:00 - 04:00 Sunday 12:00 - 04:00
-2722	The Gielgud Theatre	The Gielgud Theatre Shaftesbury Avenue London W1D 6AR	Monday to Sunday 09:00 - 00:00
-2873	Loon Tao Chinese Restaurant	31 Gerrard Street London W1D 6JT	Monday to Saturday 10:00 - 00:30 Sunday 12:00 - 00:00
-3971	Old Town 97	19 Wardour Street London W1D 6PL	Monday to Saturday 10:00 - 04:00 Sunday 12:00 - 04:00
-9408	London Chinatown Restaurant	27 Gerrard Street London W1D 6JN	Monday to Saturday 10:00 - 23:30 Sunday 12:00 - 23:00
-17247	BST And PT	Ground Floor 26 Wardour Street London W1D 6QL	Monday to Saturday 12:00 - 23:00 Sunday 12:00 - 23:00
31242	C & R Cafe Restaurant	3-4 Rupert Court London W1D 6DY	Monday to Saturday 10:00 - 00:30 Sunday 12:00 - 00:00
25162	Bella Italia	63 Shaftesbury Avenue London W1D 6LQ	Monday to Saturday 10:00 - 00:30 Sunday 12:00 - 00:00
25128	Waxy's Little Sister	20 Wardour Street London W1D 6QJ	Friday to Saturday 10:00 - 00:00 Monday to Thursday 10:00 - 23:30 Sunday 12:00 - 22:50
22205	Little Lamb	Basement And Ground Floor 72 Shaftesbury Avenue London W1D 6NA	Monday to Sunday 10:00 - 23:30
10945	Pho & Bun	76 - 78 Shaftesbury Avenue London W1D 6NG	Monday to Saturday 10:00 - 00:30 Sunday 12:00 - 00:00
9931	Bao	30 Rupert Street London W1D 6DL	Monday to Saturday 10:00 - 01:30 Sunday 12:00 - 00:00
16746	MW Buffet	Astoria House 58-60 Shaftesbury Avenue London W1D 6LS	Monday to Saturday 10:00 - 00:30 Sunday 12:00 - 00:00
18218	Golden Dragon Restaurant	28 - 29 Gerrard Street London	Monday to Saturday 10:00 - 00:30 Sunday 12:00 - 00:00
18773	Cafe T.P.T.	21 Wardour Street London W1D 6PN	Monday to Saturday 10:00 - 01:00 Sunday 12:00 - 01:00
19071	Mr Wu Restaurant	28 Wardour Street London W1D 6QJ	Monday to Sunday 11:00 - 00:00
5221	New Mayflower Chinese Restaurant	68-70 Shaftesbury Avenue London W1D 6LY	Monday to Saturday 10:00 - 04:00 Sunday 11:00 - 04:00
25160	Opium Dim Sum Parlour	Ground Floor Entrance And Second Floor To Fourth Floor 15 - 16 Gerrard Street London W1D 6JB	Sunday 12:00 - 00:00 Monday to Saturday 12:00 - 03:00
25736	Bar Rumba	Ground Floor Unit 17d Trocadero 13 Coventry Street London W1D 7ER	Sunday 09:00 - 03:30 Monday to Saturday 09:00 - 06:00

28150	Young Cheng Restaurant	39 Wardour Street London W1D 6PX	Monday to Saturday 10:00 - 23:30 Sunday 12:00 - 23:00
31770	Blue Posts Public House	28 Rupert Street London W1D 6DJ	Friday to Saturday 10:00 - 00:00 Monday to Thursday 10:00 - 23:30 Sunday 12:00 - 23:00
-31448	Little Wu	64 Shaftesbury Avenue London W1D 6LU	Monday to Saturday 10:00 - 00:30 Sunday 12:00 - 00:00
-13562	Royal Dragon Chinese Restaurant	30 Gerrard Street London W1D 6JS	Monday to Sunday 09:00 - 03:00 Monday to Saturday 10:00 - 00:30 Sunday 12:00 - 00:00
-22704	Vietnamese Restaurant	36 Wardour Street London W1D 6QT	Monday to Saturday 10:00 - 00:30 Sunday 12:00 - 00:00
-25537	Gerrard's Corner	25 Gerrard Street London W1D 6JL	Monday to Saturday 10:00 - 00:30 Sunday 12:00 - 00:00
-27470	Century Club	61-63 Shaftesbury Avenue London W1D 6LQ	Monday to Saturday 10:00 - 01:30 Sunday 12:00 - 01:00
-29525	Fratelli La Bufala	40 Shaftesbury Avenue London W1D 7ER	Monday to Sunday 09:00 - 01:00
-17263	Plum Valley	20 Gerrard Street London W1D 6JQ	Monday to Saturday 10:00 - 00:30 Sunday 12:00 - 00:00
17878	(Restaurant)	53 Shaftesbury Avenue London W1D 6LB	Monday to Saturday 10:00 - 00:30 Sunday 12:00 - 00:00
17805	Little Lamb	Basement And Ground Floor 72 Shaftesbury Avenue London W1D 6NA	Monday to Sunday 10:00 - 23:30
960	O'Neills Public House	33 Wardour Street London W1D 6PU	Sunday 08:00 - 02:00 Monday to Tuesday 08:00 - 02:30 Sundays before Bank Holidays 08:00 - 02:30 Wednesday to Saturday 08:00 - 03:30
12355	Four Seasons	23 Wardour Street London W1D 6PW	Monday to Saturday 10:00 - 05:00 Sunday 12:00 - 05:00
12989	Apollo Theatre	Apollo Theatre 31-33 Shaftesbury Avenue London W1D 7EA	Monday to Sunday 09:00 - 00:00
16744	Thai Tho Soho	42 Rupert Street London W1D 6DP	Monday to Saturday 10:00 - 00:30 Sunday 12:00 - 00:00
19511	Little Korea Ltd	2 - 3 Lisle Street London WC2H 7BG	Monday to Saturday 10:00 - 00:30 Sunday 12:00 - 00:00
23498	Kowloon Restaurant	Basement And Ground Floor Gerrard Mansions 21 - 22 Gerrard Street London W1D 6JH	Monday to Saturday 10:00 - 00:30 Sunday 12:00 - 00:00
18653	Queens Theatre	Queens Theatre Ltd Shaftesbury Avenue London W1D 6BA	Monday to Sunday 09:00 - 00:00
19576	La Scala	45 Wardour Street London W1D 6PZ	Monday to Saturday 10:00 - 00:30 Sunday 12:00 - 00:00
25400	Little Penang	Ground Floor 18 Gerrard Street London W1D 6JF	Monday to Saturday 10:00 - 00:30 Sunday 12:00 - 00:00
29515	Morada Brindisa	18 Rupert Street London W1D 6DE	Monday to Wednesday 10:00 - 00:30 Thursday to Saturday 10:00 - 01:30 Sunday 12:00 - 00:00
-22853	Caffe Concerto	50 Shaftesbury Avenue London W1D 6LW	Monday to Sunday 08:00 - 23:30

-31921	Wong Kei Restaurant	41-43 Wardour Street London W1D 6PY	Monday to Saturday 10:00 - 00:30 Sunday 12:00 - 00:00
-1305	Morden & Lea	17 Wardour Street London W1D 6PJ	Monday to Wednesday 10:00 - 00:30 Thursday to Saturday 10:00 - 01:30 Sunday 12:00 - 00:00
-138	Yoshino	59 Shaftesbury Avenue London W1D 6LF	Monday to Sunday 11:00 - 00:00
2716	The Palomar	34 Rupert Street London W1D 6DN	Monday to Saturday 10:00 - 00:30 Sunday 12:00 - 00:00
5823	Hung's Chinese Restaurant	Ground Floor To Second Floor 27 Wardour Street London W1D 6PR	Monday to Saturday 10:00 - 04:30 Sunday 12:00 - 04:30
7388	PizzaExpress	29 Wardour Street London W1D 6PS	Sunday 10:00 - 00:00 Monday to Saturday 10:00 - 00:30